

A SHOWMAN'S YARD IN THE EAST-END

BASED ON AN ACTUAL YARD IN GLASGOW. AS TRAVELLING SHOWPEOPLE ARE VERY PRIVATE, THE NAMES HAVE BEEN CHANGED.

AS REMEMBERED BY ONE OF THEIR OWN, GLASGOW IS HOME TO THE LARGEST CONCENTRATION OF TRAVELLING SHOWPEOPLE IN EUROPE. OVER 90% OF ALL SCOTTISH FAMILIES MAKE IT THEIR WINTER BASE. FOR OVER 150 SCOTTISH SHOWPEOPLE HAVE USED POST-INDUSTRIAL LAND, HIDDEN NOOKS & WINTER CARNIVAL SITES AS THEIR HOME AFTER TRAVELLING THROUGH THE SUMMER. THIS YARD IS BASED ON THE ONE I STILL THINK OF AS HOME, AND IS TYPICAL OF THE MANY TUCKED AWAY INTO THE CITY PARK.

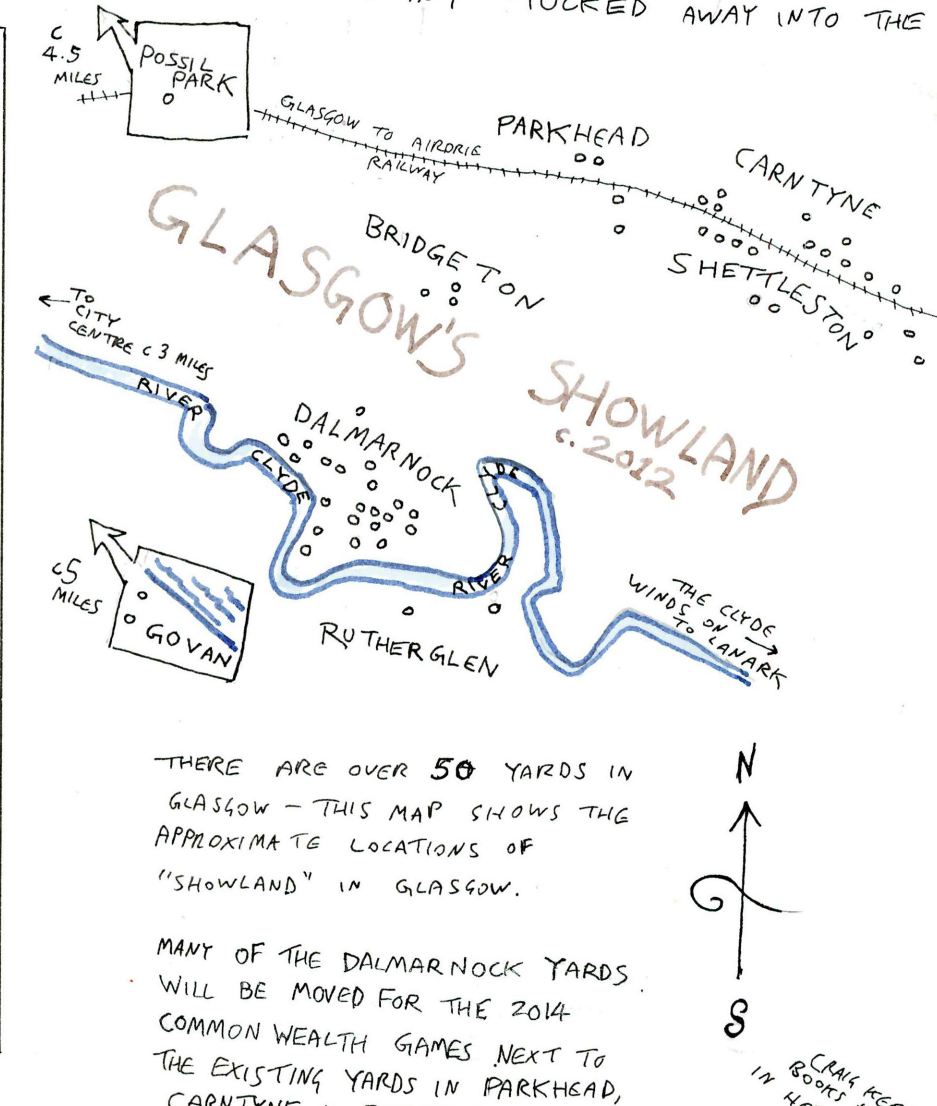
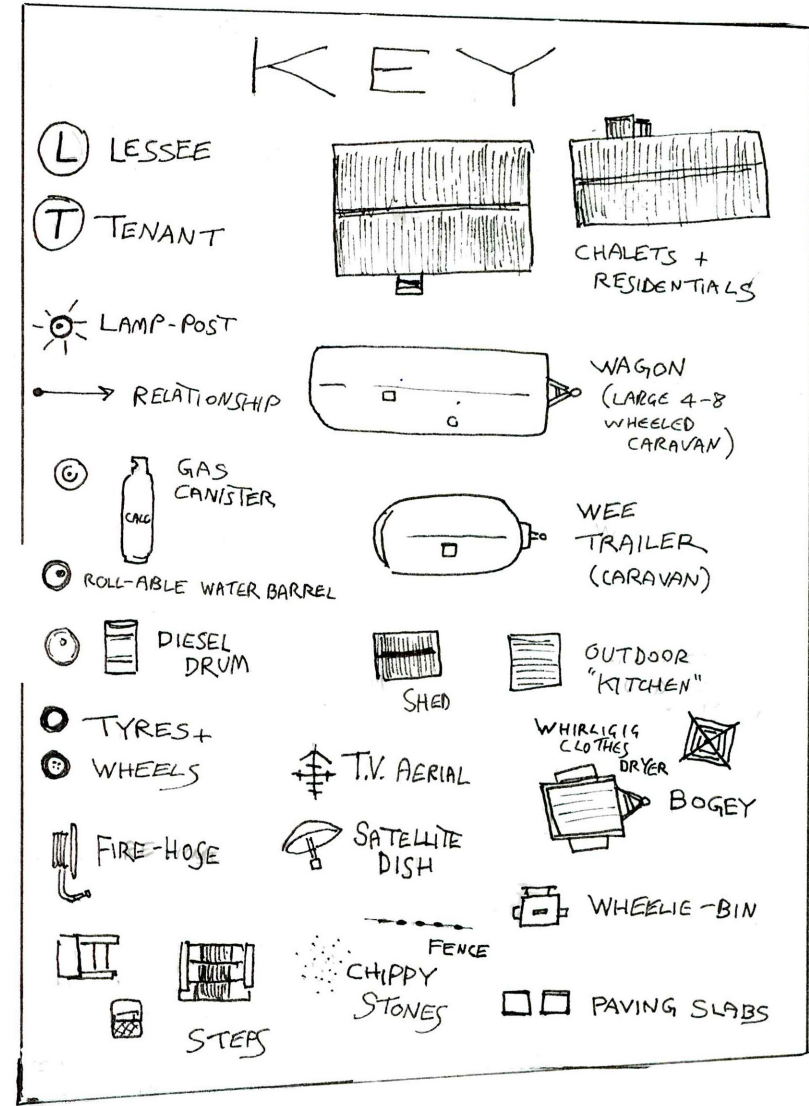

NORTH END
THE BACK OF THE NORTH END IS OCCUPIED BY THE KELSO FAMILY AND THEIR RELATIVES. IT IS THE PREFERRED SPOT FOR THE LONG-TERM, LESS NOMADIC RESIDENTS, THOSE GENERATIONS OF KELSO CURRENTLY LIVE ON THE YARD.

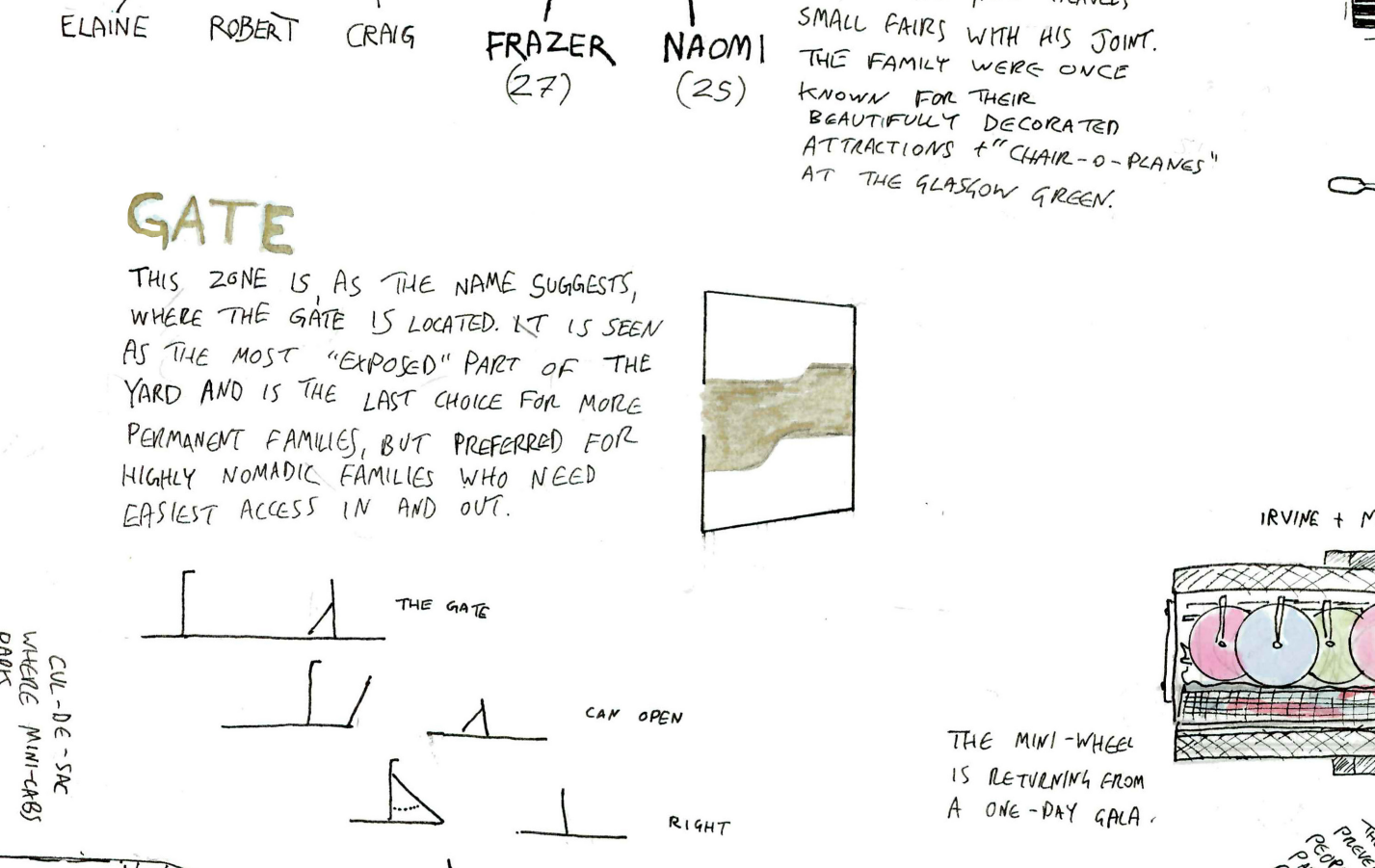
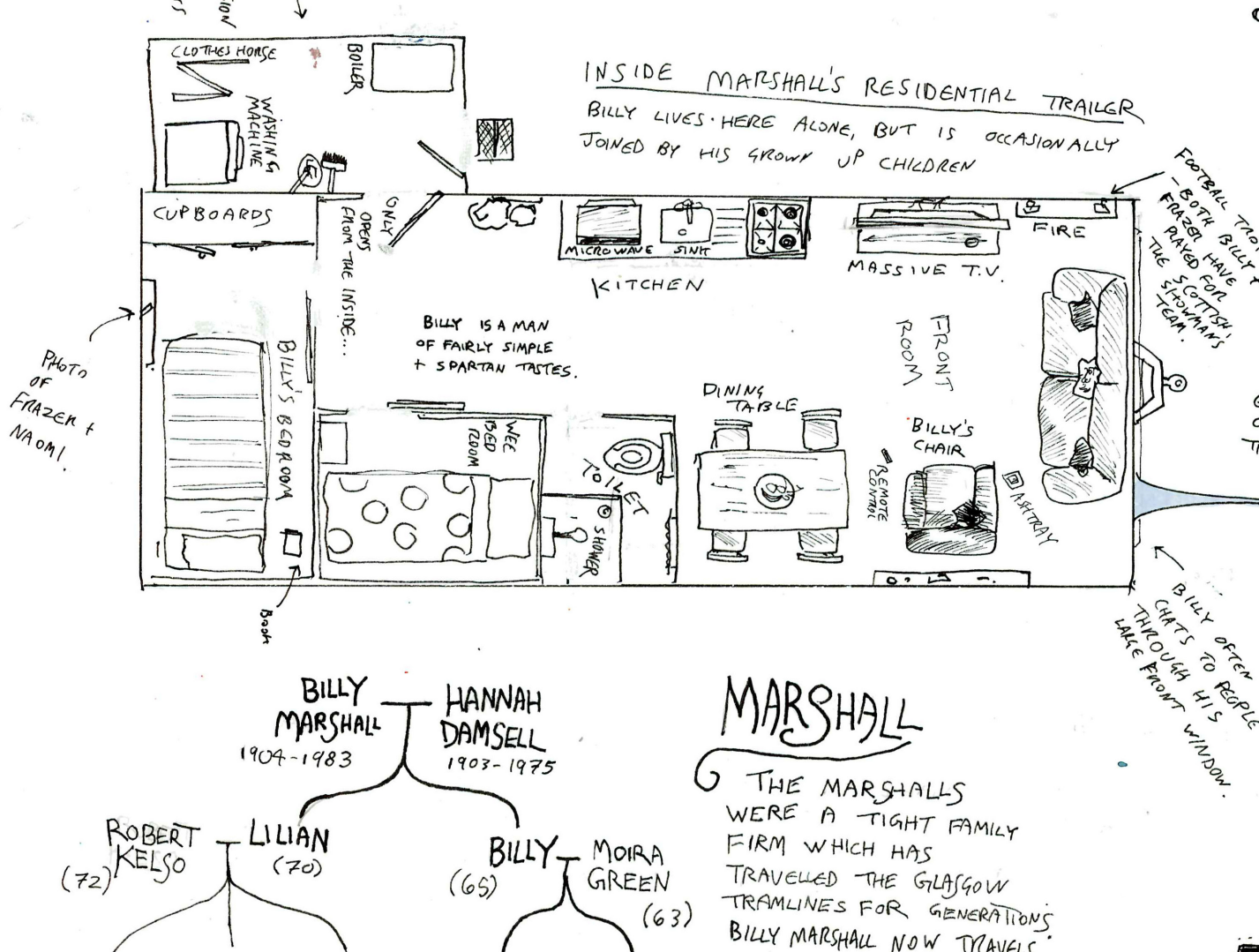
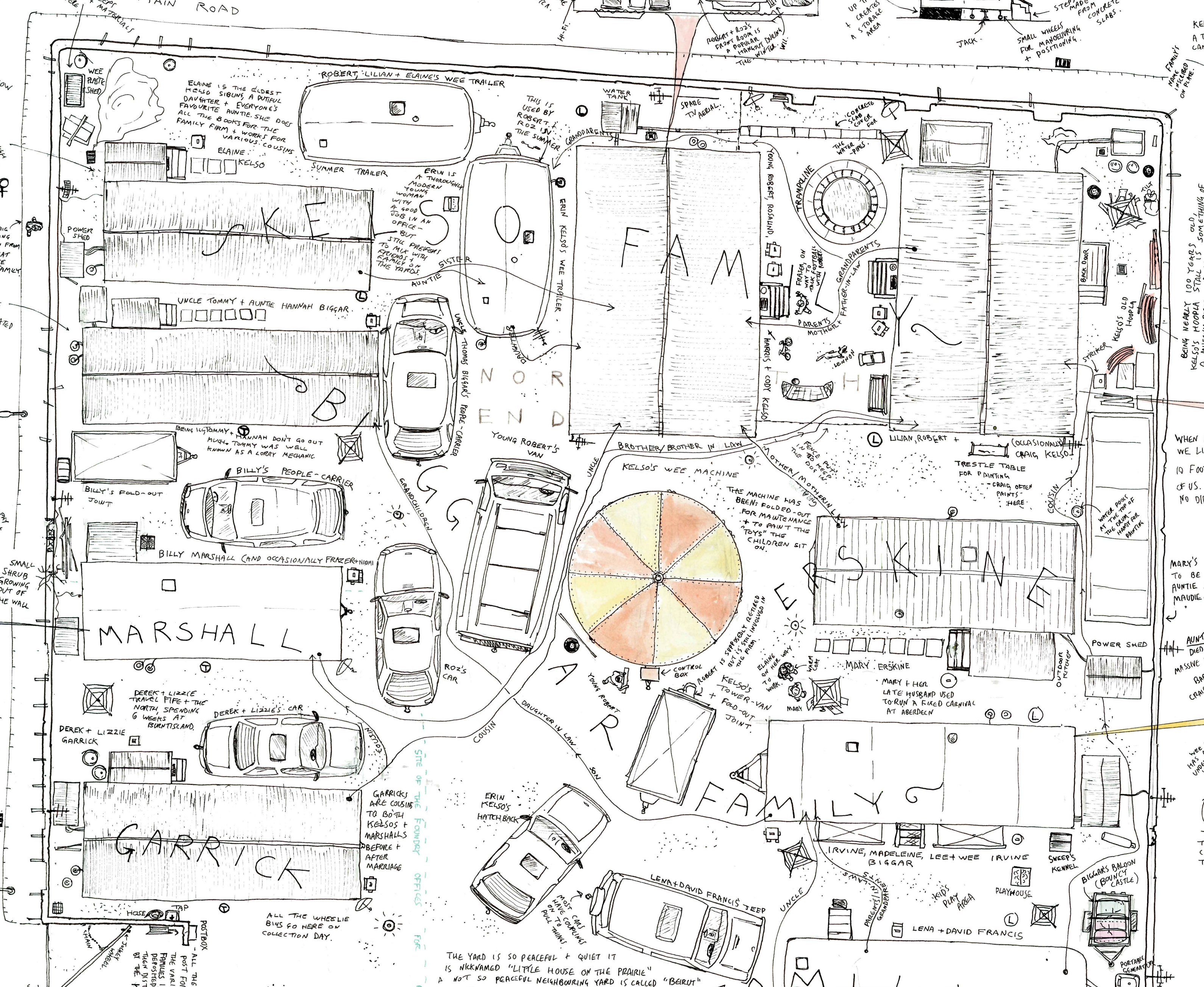
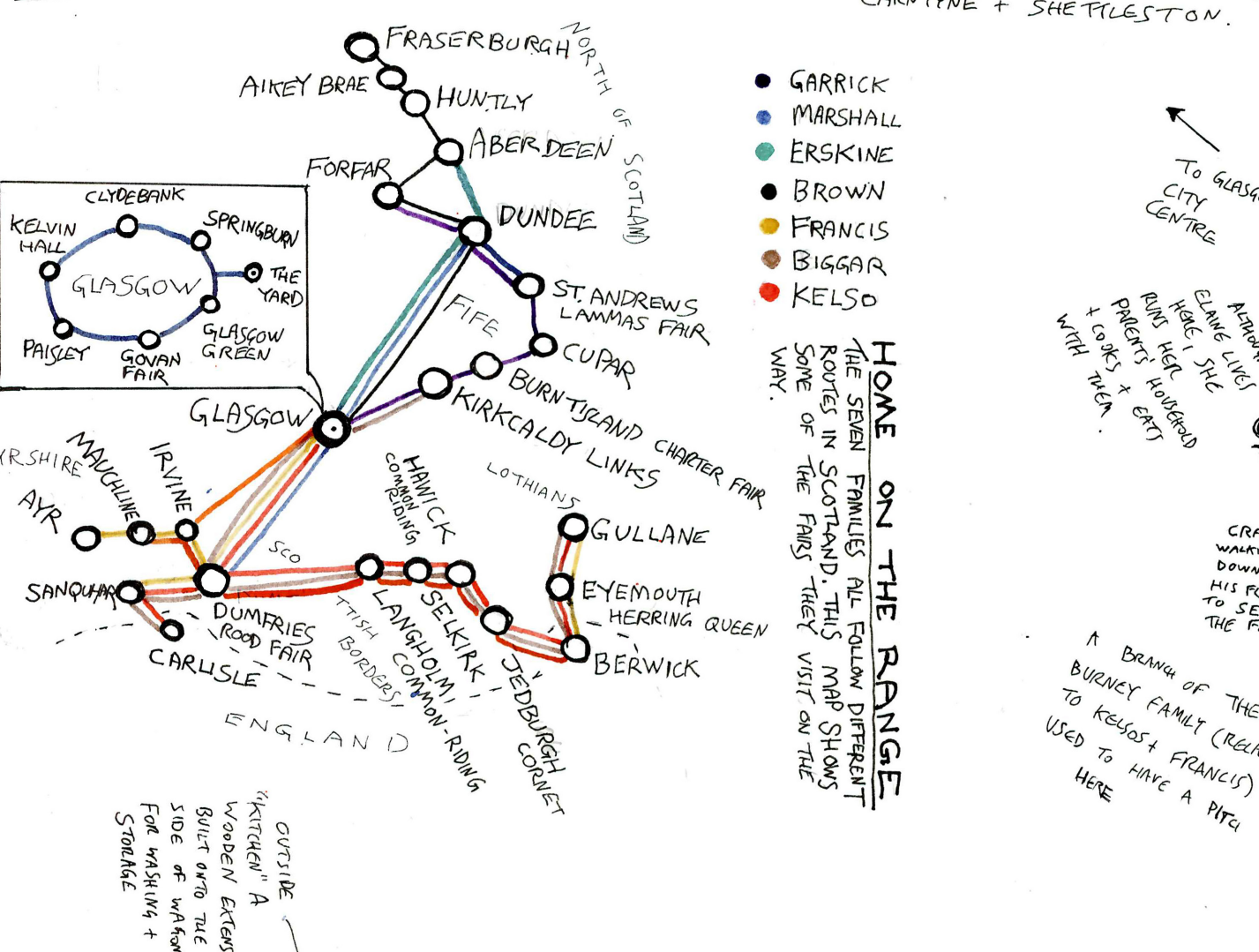
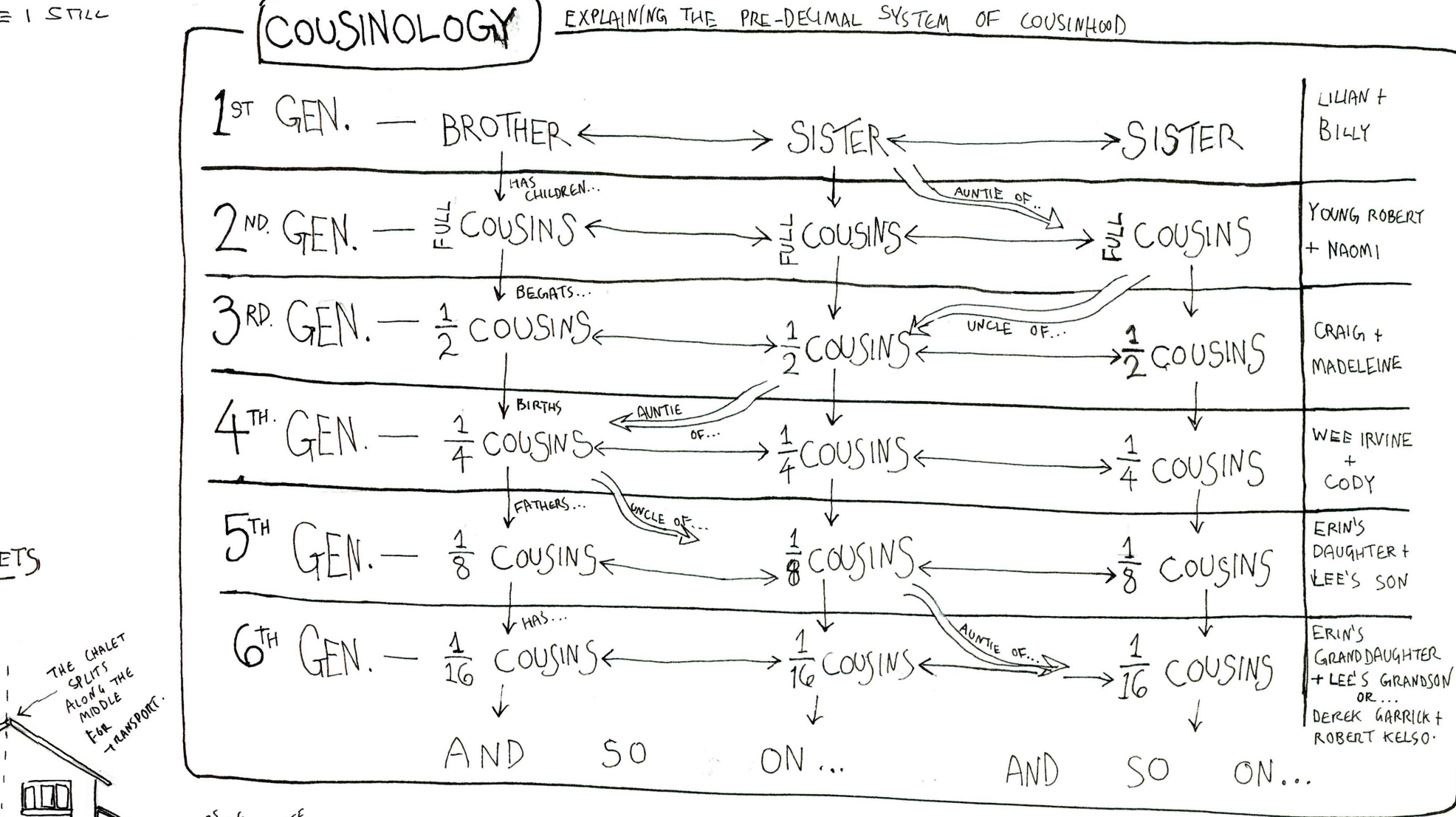
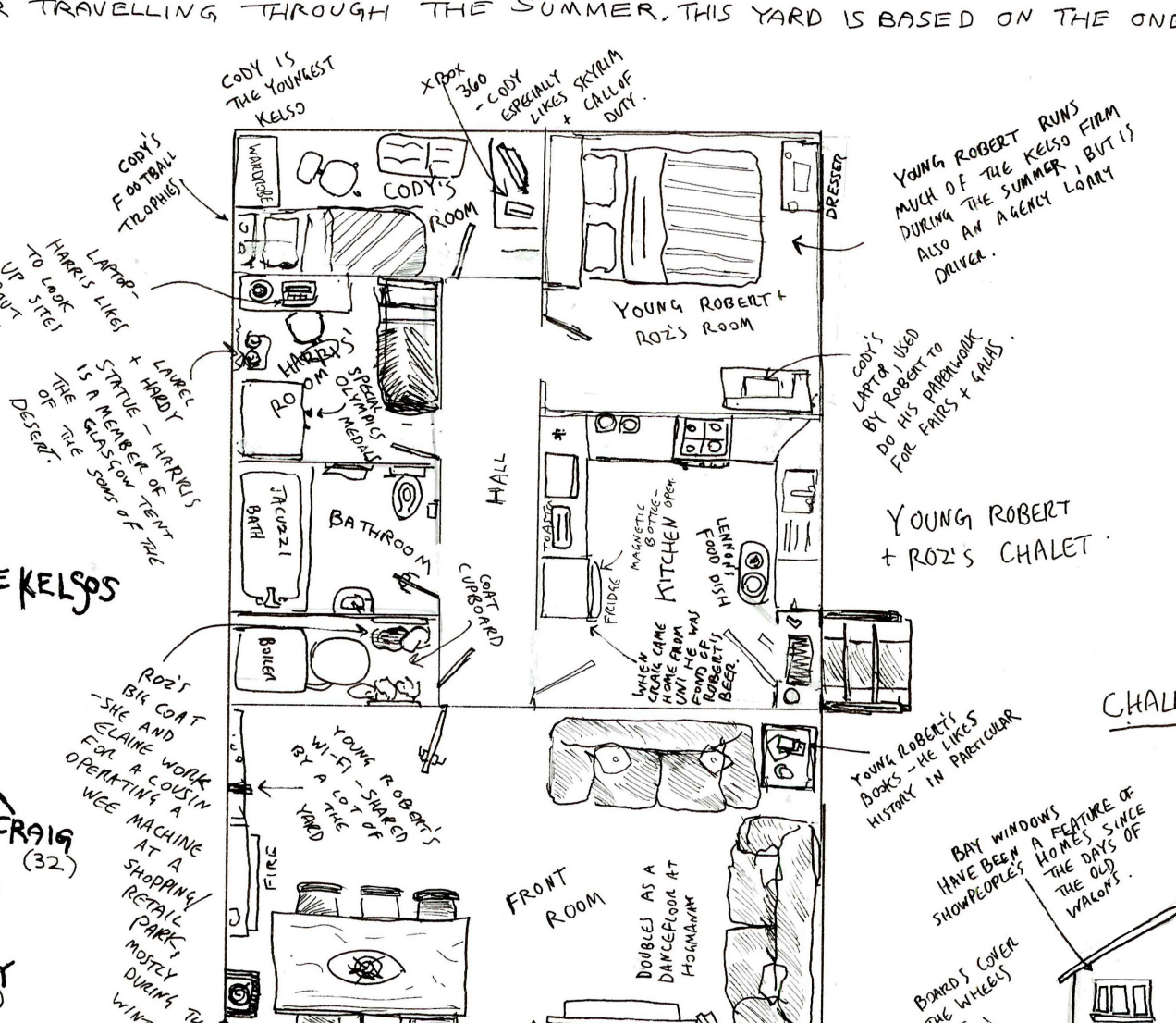

SOME USEFUL TERMS
MIXING WAGON - A RIDE-KIT'S RIDE.
BLISS - INMATEABLE BOUNCY COT.
JOINT - STALL, HOODS - ROUND STALL.
UNCLE/NEAUNT - PALATE FORM OF ADDRESS TO ANY TRAVELLER OF THE OLDER GENERATION.
YARD - WINTER QUARTERS USED BY TRAVELLING SHOWPEOPLE.
GARDEN - DITTO. ERM - FAMILY WHO TRAVEL & OPERATE FRINGE THEATRICALS.
LIGHTING SET - KAMP TO REST AS A CARAVAN, CANS IN BENCHES SIDE, OR LABEL SETS POWERED BY LAMP. - WOODEN BEAMS USED TO LEVEL UP STAYS + STAYS.

