

TRAVELLER OLOGY

KNOWLEDGE + EXPERIENCE x EXPEDIENCY

SHOWMAN'S YARD AT 24 BACKCAUSEWAY, GLASGOW

POPULATION: 35 (MAXIMUM)

(GOOGLE EARTH, 55°51'09.23"N 4°11'30.87"W)

COMPILED FROM NOTES TAKEN CHRISTMAS/NEW YEAR 2008/9 AND MOST RECENT VISIT.

HISTORY:

Backcauseway is a dis-used Iron Foundry located near Celtic Park. It began its life as a Showman's Winter yard in 1966/7, when the Miller, Lawrence & Broughton families formed a consortium to lease the property. The three families were linked by common ancestry and were looking for alternative accommodation. The yard or "Ground" is renowned for its peaceable - some might say bring-atmosphere that has won it the monicker "Little house on the Prairie". Day-to-day running is overseen by the Millers, rents shared by the whole consortium.

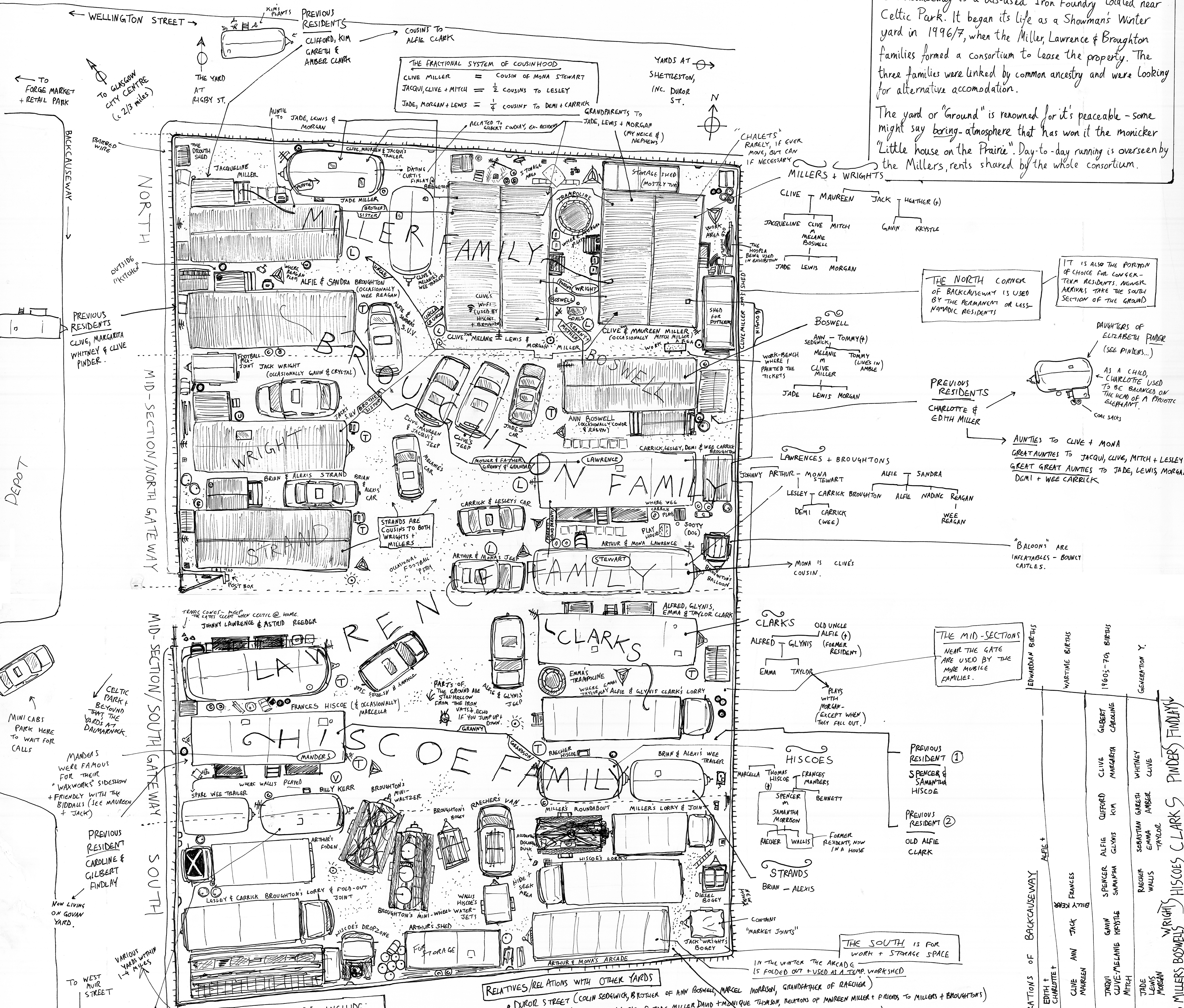

IT IS ALSO THE PORTION OF CHOICE FOR LONGER-TERM RESIDENTS, AS WELL AS THOSE WHO TAKE THE SOUTH SECTION OF THE GROUND.

DAUGHTERS OF ELIZABETH PINDER (SEE PINDERS...)

AS A CHILD, CHARLOTTE USED TO BE BALANCED ON THE HEAD OF A PROWSE ELEGANT.

COLE SACKS

PREVIOUS RESIDENTS CHARLOTTE & EDITH MILLER

AUNTIES TO CLIVE + MONA GREAT AUNTIES TO JACQU, CLIVE, MITCH + LESLEY GREAT GREAT AUNTIES TO JADE, LEWIS, MORGAN DEMI + WEE CARRICK

"BALLOONS" ARE INFLATABLES - BOUNTY CASTLES.

THE MID-SECTIONS NEAR THE GATE ARE USED BY THE MORE MOBILE FAMILIES.

CLARKS ALFRED - GLYNIS (FORMER RESIDENT) EMMA TAYLOR

EMMA TAYLOR PLAYS WITH MORGAN - (EXCEPT WHEN THEY FALL OUT.)

PREVIOUS RESIDENT 1 SPENCER & SAMANTHA HISCOE

PREVIOUS RESIDENT 2 OLD ALFIE CLARK

THE SOUTH IS FOR WORK + STORAGE SPACE

IN THE WINTER THE ARCADE IS FOLDED OUT + USED AS A TEMP. WORKSHED

- NEARBY YARDS INCLUDE:
- RIGBY STREET
 - CARNTYNE
 - DUROR ST. SHETLESTON
 - MCINTYRE'S OFF DUKE ST.
 - THE "SHOWMAN'S QUARTER" AT DALMARNOCK

- RELATIVES/RELATIONS WITH OTHER YARDS
- DUROR STREET (COLIN SEDGWICK, BROTHER OF ANN BOSWELL, MARCEL MORRISON, GRANDFATHER OF RAECHER)
 - BRIDGEGTON (COURTIS FINDLAY, BIF OF JADE MILLER, DAVID + MONIQUE THOMAS, RELATIONS OF MAUREEN MILLER + FRIENDS TO MILLERS + BROUGHTONS)
 - GOVAN (OWNED BY JOHNSTONS, COUSINS TO CLIVE MILLER, NOW HOME TO GILBERT + CAROLINE FINDLAY)
 - RIGBY STREET (FRIENDS OF MILLERS, HISCOE + BROUGHTONS, I.E. THE BLOCKLEY + HILL FAMILIES)
 - PROXBURN (EAST OF SCOTLAND) (MORRISON, RELATIVES OF RAECHER HISCOE'S FRIENDS TO MILLERS + CLARKS)
 - "CHALET" VALLEY (PINDERS, RELATED TO MILLERS, LAWRENCE + BROUGHTONS)

It is important to understand which objects the traveller has at their disposal to define their polis shafting space with. Most important is the family home - a trailer with two wheels or the wagon with four. Each of these has a main window, a toubur for pulling and of course a door with removable steps linking it to the ground. Then there are the transports - lorries and jeeps, and some of the transports themselves are also rides - which can double as workspaces. Every site is unique, laid-out according to time, terrain + feasibility

TRAVELLER-OLGY EXCERPTS:

The Agricultural & Charter fairs of Europe combined essential economic functions with the temporary suspension of social norms and the rowdy anarchic elements of theatre, performance, contortion and menagerie. Entertainers and sellers joined forces to make the entity that was the fairground, and fed off each other in the manner of cooperative capitalism. The ancient fair was a warren of Machiavellian attractions, distractions and in-between, transactions.

WHAT THEY DO

MILLERS - STALLS + KIDDIES RIDES
 BROUGHTONS - STALLS + KIDDIES RIDES + SIDESHOW + BALLOON
 LAWRENCE - STALLS + ARCADE
 HISCOE - SMALL RIDES + BIG RIDES
 CLARKS - STALLS
 WRIGHTS - STALLS
 BROUGHTON MRS - STALLS
 STRANDS - STALLS

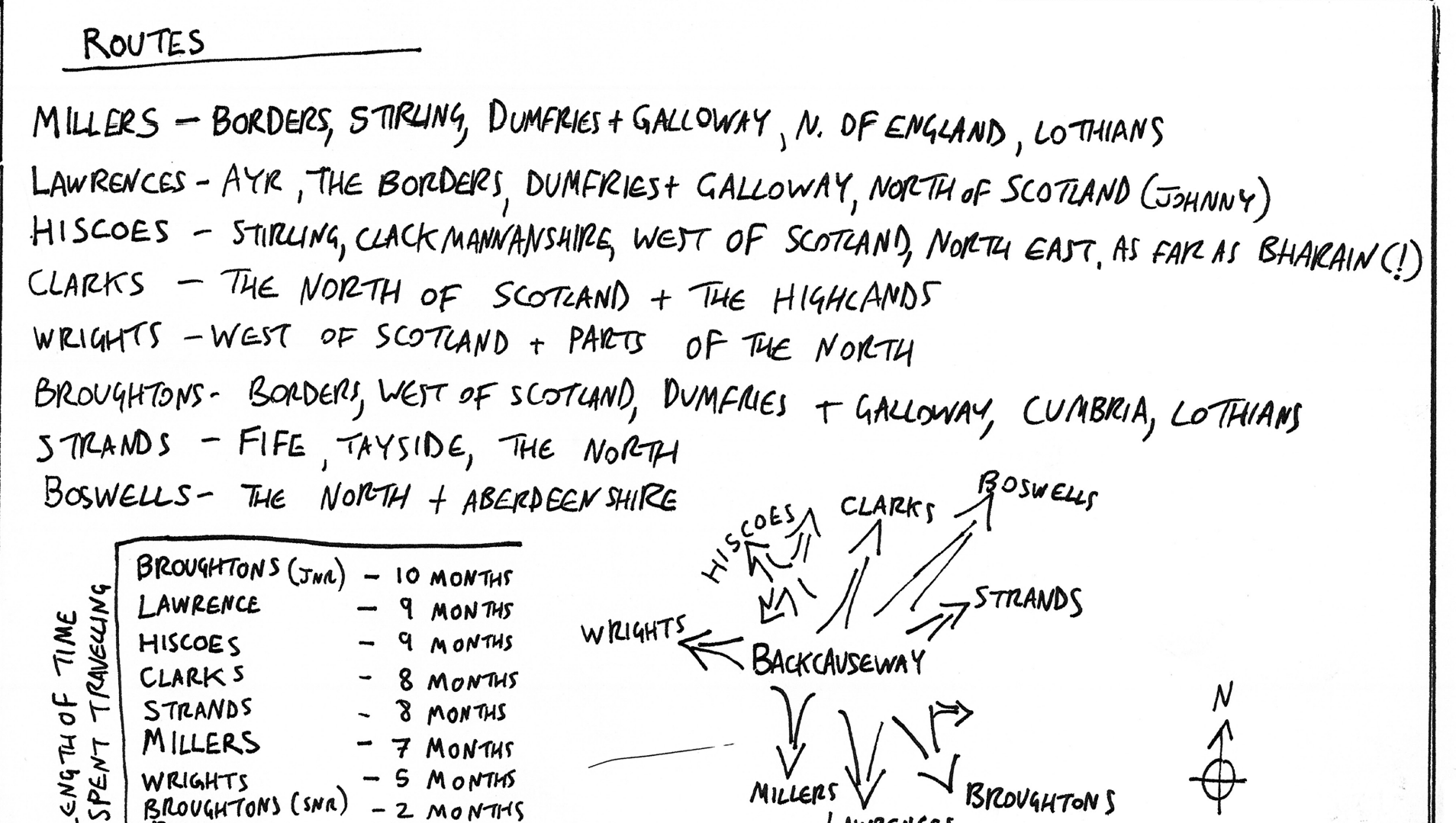

- MISTAKES & OMISSIONS**
- CAB THAT PULLS BROUGHTONS WAGON
 - JOHNNY LAWRENCE'S LARRY IS MISSING, WAGON NOT IN IDEAL PROPORTIONS.
 - CARRICK BROUGHTONS COTTAGE HAS BEEN MISSED OUT!
 - GATE LOOKS A BIT TOO TIGHT
 - NOT SURE I GOT THE LAMPOST RIGHT
 - HISCOE'S WAGON WRONG WAY ROUND
 - LOT OF RIDES SEEM TO BE MISSING

SHEET A:

TRAVELLEROLOGY